

- SCHOOL TERM DATES**
- Monday 28th October - Half Term •
 - Monday 4th November— Non pupil Day
 - Tuesday 5th November— Back to School
 - Monday 23rd December—Start of School holidays
 - Monday 6th January—Non pupil Day
 - Tuesday 7th January— return to School
 - Monday 17th February - Half term
 - Monday 24th February - Return to School
 - Monday 7th April -Easter Holidays
 - Tuesday 22nd April—Return to School
 - Friday 23rd May—Non Pupil Day
 - Monday 26th May—Half Term
 - Monday 2nd June—Return to School
 - Wednesday 23rd July— School Holidays



Silver End Academy Prospectus Grow ♦ Flourish ♦ Succeed

16TH SEPTEMBER 2024

A Message from Head of School

I hope this first newsletter finds you well. As we settle into the new school year, I wanted to take a moment to share some updates and reflections on the start of term. It's always an exciting time when the hallways fill with the buzz of learning, and I'm thrilled to see both familiar and new faces ready to embark on another year of growth and discovery.

A GREAT START

The first few weeks have been a success! Our students have transitioned smoothly into their new classes, and the atmosphere has been one of positivity and enthusiasm. Teachers have been busy preparing engaging lessons, and it's been wonderful to witness our learners getting stuck into their studies and making new friendships. I'd like to commend the students for their respectful behavior and eagerness to learn—it truly sets the tone for a successful year ahead.

HEALTH & SAFETY REMINDERS

With the change of season upon us, please remind your children to dress appropriately for the weather, especially as we encourage outdoor learning whenever possible. Please make sure they have a coat with them in case it rains during playtime. Additionally, I'd like to remind everyone to continue following our health and safety guidelines to ensure that we keep the school environment safe for all. This includes not bringing dogs onto the playground when dropping off or picking up children. Please leave them by the front of the school.

PARENT-TEACHER COMMUNICATION

A key part of ensuring every student's success is open communication between home and school. If you haven't already please download ClassDojo and link with your class teacher. Teachers will send regular updates and pictures of the children learning. It will also be where they will notify you of homework, spelling or timetable changes.

EXTRACURRICULAR ACTIVITIES

Our extracurricular program is off to a fantastic start. Whether your child is interested in sports, music, debate, or any other activity, there's something for everyone. These activities are a wonderful way for students to develop skills outside the classroom, build teamwork, and have fun!

In conclusion, I'd like to thank you for your continued support. Together, we can ensure that this school year is full of achievements, growth, and memorable experiences for all our children.

Morning Drop Off Map

To aid everyone's understanding, please find attached two maps that outline where children should enter and exit the building each day.

If you have a child in year 1 or 2, please note that drop-off and pick up will now be to and from your child's classroom door rather than lining up.

Please note that to ensure teaching staff can welcome and safeguard the children, morning messages should be sent via class dojo rather than in person.

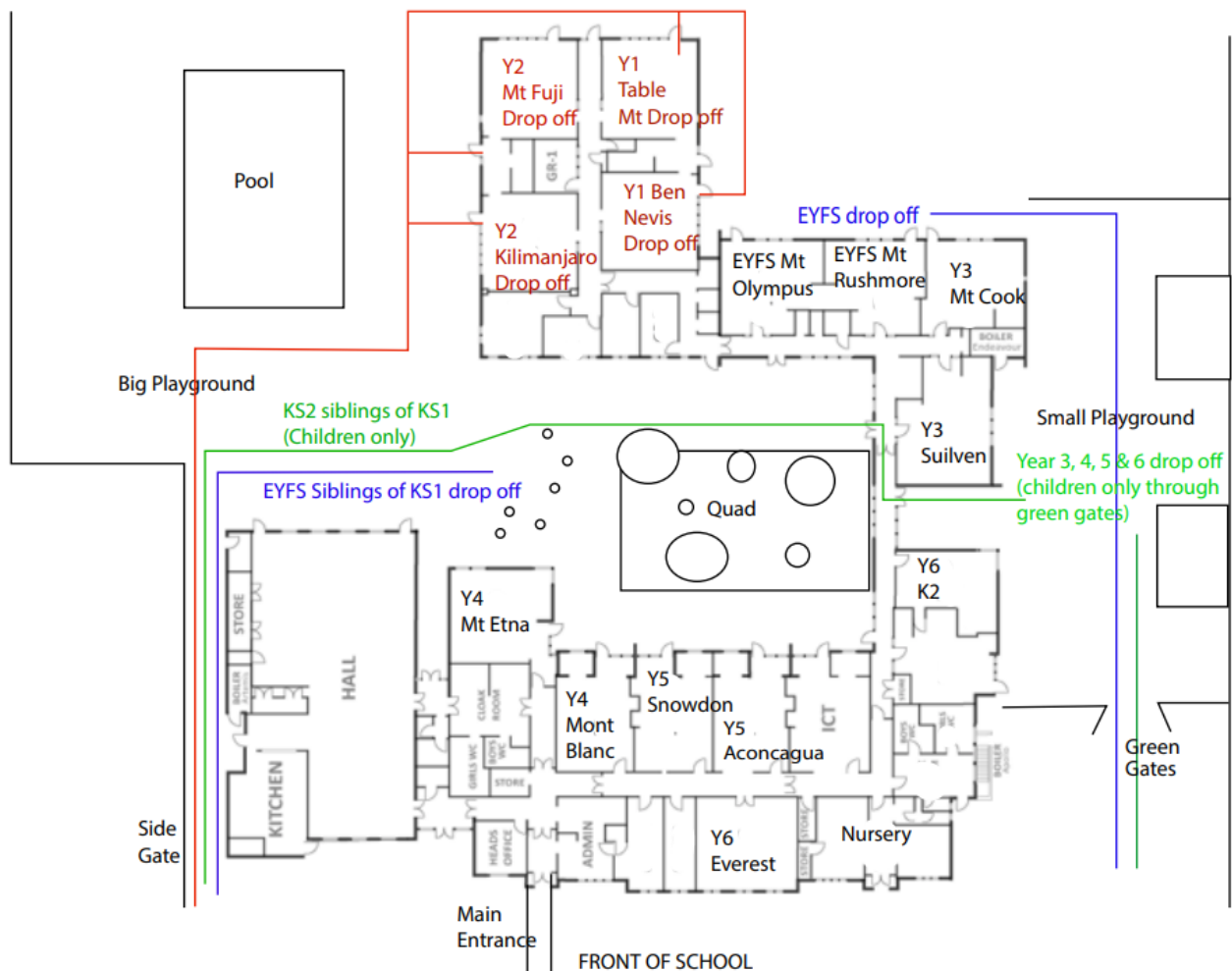

Afternoon Collection Map

To ensure that we bring the correct children to the hall for collection (those who are EYFS or KS2 siblings of KS1 children). Please look out for and complete the permission form which will be sent out following this email which will close at 8:00am on Monday 16th September.

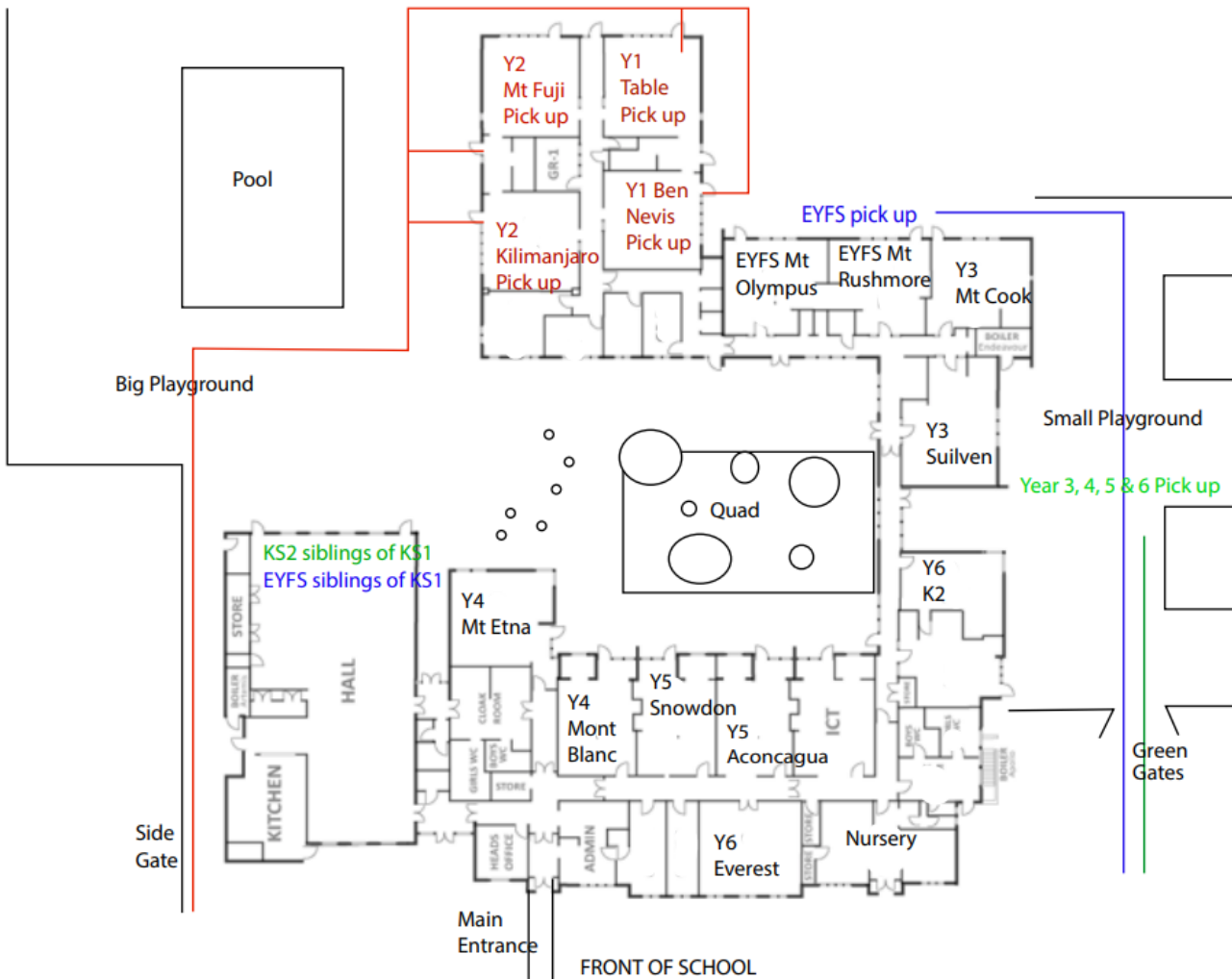



We are in desperate need of some volunteers to help us with a couple of projects in school.

- 1) We would love it if someone from our school community could help us sort and organise our books. As we have grown to a two-form entry school, space is limited and we have had to close our library. We would like to create three book-lined intervention spaces, but the first steps is organising the books. Do you have a passions for books and reading? Could you be part of brining these spaces to life for the children?
- 2) With the help of the PTA we would like to develop our quad area this year into an outdoor classroom. Are you, or do you know someone with landscaping experience? Would yu be willing to give your time and experience to drawing up some initial plans?

If you can fulfil either of these, please get in touch with the school office by emailing adminsil@inspiresmat.co.uk



Dear parents and carers,

Drop off and collection by older siblings

It has recently been noted that parents and carers would like more clarity around the issue of siblings collecting younger children from school and therefore, we offer the following as clarification:

It is the parent/carer's responsibility to ensure that the child is dropped off and collected by a responsible person if it is not safe for the child to walk home unsupervised. There is no minimum age set in law when a young person is allowed to remain in charge of another child; however it is an offence to leave a child alone if it places them at risk. This can include in the care of an older sibling if the level of supervision is 'likely to cause unnecessary suffering or injury to health' (Children and Young Persons Act). Therefore parents/carers must understand and be prepared to take responsibility for anything that should go wrong in their absence. Parents are also responsible for the care and safety of their eldest child, even while that child is acting in a caring role for younger siblings.

At Silver End Academy, we allow siblings over the age of 15 to drop off or collect a child providing that we have been informed in writing; however The Royal Society for the Prevention of Accidents and the NSPCC recommend that no one under 16 should be left to care for a younger child for more than a short period of time. The school reserves the right to refuse to allow a person between the ages of 15 and 18 to take responsibility for accompanying a pupil to or from school should we have any concerns about that person's suitability to do so. The suitability of a sibling, or other young adult, caring for a younger child will be considered on a case by case basis, by making a judgment of the potential risks of this arrangement; the maturity of the child collecting/being collected; the length and nature of the journey home, the behaviour and relationship of the children collecting/being collected.

Excerpt taken from "Please keep an eye on your younger sister": sibling supervision and young children's risk of unintentional injury: *Injury Prevention*, August 2010

If you require any further clarification, please do not hesitate to come and talk to a member of staff.

It is known that, when parents supervise their children, it reduces the chance that a child will be injured. However, when older siblings supervise younger children, there is an increased risk of injury.

The idea behind the research was to explore why the risk of injury to young children increased when they were supervised by older siblings. The researchers found that mothers were more likely to spot and remove hazards, whereas older siblings were more likely to interact with the hazards in front of the younger children (for example, an older child may make themselves a hot drink and put it within reach of a young child, whereas the mother would be more likely to keep hot drinks well away from toddlers).

It is well known that younger children tend to copy their older siblings - and indeed, this was found to be the case during the study. Children also behaved in a more risky manner when they were supervised by a sibling; however, their sibling babysitters were less attentive to that risk than their mothers would be. The problem was compounded by the fact

Being Active for others

This year the school is going to promote 'being active for others' through a series of activities and fundraising efforts.

Mrs Wightman and Mrs Taylor are kicking things off in September with 100 kilometre challenges.



Mrs Wightman is running 100K in September to raise money for Great Ormond Street.

If you would like to sponsor her please use this QR code.



Mrs Taylor is walking 100 kilometers in September to help raise funds and awareness for the Sands, a charity which supports families affected by baby loss.

In April Mrs Laughlin is taking on the London Landmarks half marathon for Great Ormond Street. If you would like to sponsor her please follow this link or QR code.



https://www.justgiving.com/page/sarah-laughlin-1724404220977?utm_medium=fundraising&utm_content=page%2Fsarah-laughlin-



Being Active for others

With the help of the PTA we will also be organising a number of activities across the year for children and parents to get involved with. Look out for news of the following to get involved:



- Santa-Run around the village for staff and parents in December
- Sponsored dance-a-thon in May
- Sponsored obstacle course and colour-run around the school field in the summer term

Through these events we hope to inspire and educate children to see how they can help others and the community around them.



MEET
.....the.....
TEACHER

I would like to invite Key Stage One and Key Stage Two parents and carers to meet your child's class teacher on Tuesday 24th September after school. Mrs Chaplin and I will entertain the children in the hall to give parents and carers an opportunity to hear about what your child will be studying this year, ways that you can help at home, and other house-keeping bits and pieces. For parents of siblings we will stagger the times as much as we can, but we will also ensure that information shared during the talk is distributed for anyone who is unable to attend. Whilst you are waiting for your child's talk to start, please do have a look at the classroom and their work – or just have a chat with fellow parents.

Please enter the school where you would normally collect your child from.

Year 1 & 2 Teacher Presentation: 3.10pm

Year 3 & 4 Teacher Presentation: 3.30pm

Year 5 & 6 Teacher Presentation: 3.50pm

Wrap Around Care

Our Hang Out Club will run between 3 & 5.30pm Monday—Thursday. It is currently £8 for 3-5pm and £12 until 5.30pm. To book please do so via ParentMail the week before you require the service.

Breakfast Club

Monday-Friday 7.40 - 8.30am

Breakfast Club runs every morning (term time) throughout the year and is open to all pupils at Silver End Academy. The cost per day is £3.50, payable on the day or in advance. The purpose of the Breakfast Club is to provide the opportunity for children to eat breakfast within a safe and friendly environment

Clubs

School clubs will commence the week of 16th September. A clubs list has already been distributed.

Please note reception children can start school clubs in the Summer Term.

Parking Outside School

When dropping off/picking children up from school, please can we remind you that you must not park or stop on the yellow lines outside school between 8- 9.30 am and again 2.30-4pm. We have a small number of parents who have been invited to use the disabled spaces in our small car park. School car parks should not be used unless previously agreed. Please be considerate and Keep our children safe!! If you are concerned that poor parking has caused a safety issue, has blocked your drive, is not following the law or has caused the blockage of the road for emergency vehicles, please follow the links indicated in this website .

[Enforcement Requests - North Essex Parking Partnership](#)



**BRANDED
UNIFORM
CAN BE
PURCHASED
ONLINE FROM
SCHOOL
TRENDS AND
PERSONALISE
ONLINE
USING THESE
LINKS.**

www.schooltrendsonline.com/uniform/SilverEndPrimarySchoolCM83RZ

www.personalise-uk.co.uk/products/school-shop

Uniform

Dress

It is the expectation of the school that all children who attend the school, wear the correct uniform.

Boys and girls are welcome to wear:

- ◆ Plain grey or black trousers, tailored shorts, tunic dress or skirt
- ◆ Red gingham dresses for Summer uniform
- ◆ Plain white or grey shirt/polo shirt
- ◆ Maroon sweatshirt/jumper, with or without the school logo
- ◆ Plain black, grey, maroon or white socks
- ◆ Plain black trainers with black soles or black school shoes



P.E. Outfits

- ◆ Plain white T-shirt/polo shirt [no logos]
- ◆ Plain black shorts [no logos or stripes]
- ◆ Plain black plimsolls or plain black trainers
- ◆ Plain Tracksuit for outdoor activities – Black, navy or dark grey with no logos



Jewellery & Hair

The only jewellery permitted is a watch and plain ear studs which your child must be able to remove for PE lessons. If they are unable to do so, please leave earrings out for PE days.

No earrings or jewellery whatsoever may be worn during P.E. or Games sessions. (Should your child be having their ears pierced please consider having this done at the start of the summer holidays so that they do not miss P.E. or swimming lessons).

Hair should be neat and tidy. Extreme or “Attention seeking” styles or adornments such as extra large bows are not suitable.

Menu for week commencing 16/09/2024

Silver End Academy

Monday

Summer Street Food - Hot Dog

served with jacket wedges and mixed leaf salad.

Tuesday

Spaghetti Bolognese

served with salad bar

Wednesday

Roast Gammon with a (Yorkshire) Twist!

Larger Yorkshire Pudding with Gammon, New Potatoes, Carrots and Broccoli inside.

Thursday

Chicken Curry

served with wholemeal rice and salad bar

Friday

Fish Fillet

served with crispy chips, baked beans and peas

Sweet Treat Friday – Ice Lolly

Available Everyday
A healthy salad bar, fresh fruit, yoghurt and bread

Breaded Quorn Burger - V

served with jacket wedges and mixed leaf salad.

Jacket Potato with a choice of toppings

Feta and caramelised Onion Quiche - V

served with salad bar.

Jacket Potato with a choice of toppings

Quorn Sausage - V

Larger Yorkshire Pudding with Gammon, New Potatoes, Carrots and Broccoli inside.

Jacket Potato with a Choice of toppings

Cheesy sausage(less) roll - V

served with salad and coleslaw

Jacket Potato with a choice of toppings

Vegetable Pattie - V

served with crispy chips, baked beans and peas

Jacket Potato with a choice of toppings

Week 3



Fresh
All our food is cooked fresh each day.

Healthy
Our pasta, rice and breads are healthy wholemeal products.

Checked
We always use reputable suppliers and where possible use local produce.



Menu

Menu for week commencing 23/09/2024

Silver End Academy

Monday

Pepperoni Pizza

Served with salad and coleslaw

Cheese and Tomato Pizza

Served with salad and coleslaw

Tuesday

Minced Beef Chilli & Nachos

served with wholemeal rice and sweetcorn

Cheese whirl – V

served with wholemeal rice and sweetcorn

Wednesday

Roast Chicken

served with roast potatoes, carrots and fine green beans

Quorn Sausage - V

served with roast potatoes, carrots and fine green beans

Thursday

Sausage with Pasta in Tomato Sauce

served with garlic bread and broccoli

Quorn Chilli - V

Served with Garlic Bread and Salad Bar

Friday

Jumbo Fish Fingers

served with crispy chips and petit pois.

Quorn Dippers - V

served with crispy chips and petit pois.

Sweet Treat Friday – Iced sponge cake

Jacket Potato with a choice of toppings

Week 1



Fresh
All our food is cooked fresh each day.

Healthy
Our pasta, rice and breads are healthy wholemeal products.

Checked
We always use reputable suppliers and where possible use local produce.

Available Everyday
A healthy salad bar, fresh fruit, yoghurt and bread



Menu

FREE SCHOOL MEALS

EYFS & Key Stage 1

Children in reception, year 1 and year 2 automatically get free school meals. This is called Universal infant free school meals (UIFSM) and you do not need to apply for it.

If you are a low income family and your child will be using free school meals, you can support your us by letting us know you are using the service. We will then be eligible to apply for more funding to support the provision of education for children in the school.



Children in year 3 and above

If your child is in Year 3 or above, and you receive one of the listed qualifying benefits, your child may be eligible for FREE school meals.

- Income Support
- Income-based Jobseeker's Allowance
- Child Tax Credit (not Working Tax Credit), with an annual income below £16,190
- Pension Guarantee Credit
- Employment and Support Allowance, income related
- Support under part 6 of the Immigration and Asylum Act, 1999
- Working Tax Credit run-on, paid for 4 weeks after you stop qualifying for Working Tax Credit
- Universal Credit, with a household income of £7,400 or less (after tax and not including any benefits you get)

In accordance with national Department for Education advice, we cannot accept evidence of provisional tax awards.

When to apply

CHILDREN MOVING FROM YEAR 2 TO YEAR 3

For children moving from year 2 to 3 in September, you should make an application for free school meals from 1 August, selecting the school the child will be attending. Please do not apply earlier than this date.

CHILDREN MOVING FROM YEAR 6 TO YEAR 7

For children moving from year 6 to 7 in September, you should make an application for free school meals from 1 August, selecting the school the child will be attending. Please do not apply earlier than this date.

ALL OTHER YEARS

You can apply at any time throughout the year.

To apply

follow the link below or google 'free school meals Essex'

<https://educationportal.essex.gov.uk/CitizenPortal/en>





Connected Learning Term and Holiday Dates Academic Year 2024-2025

September 2024							October 2024							November 2024							December 2024						
M	T	W	T	F	S	S	M	T	W	T	F	S	S	M	T	W	T	F	S	S	M	T	W	T	F	S	S
						1		1	2	3	4	5	6					1	2	3							1
2	3	4	5	6	7	8	7	8	9	10	11	12	13	4	5	6	7	8	9	10	2	3	4	5	6	7	8
9	10	11	12	13	14	15	14	15	16	17	18	19	20	11	12	13	14	15	16	17	9	10	11	12	13	14	15
16	17	18	19	20	21	22	21	22	23	24	25	26	27	18	19	20	21	22	23	24	16	17	18	19	20	21	22
23	24	25	26	27	28	29	28	29	30	31				25	26	27	28	29	30		23	24	25	26	27	28	29
30																					30	31					
January 2025							February 2025							March 2025							April 2025						
M	T	W	T	F	S	S	M	T	W	T	F	S	S	M	T	W	T	F	S	S	M	T	W	T	F	S	S
		1	2	3	4	5						1	2						1	2		1	2	3	4	5	6
6	7	8	9	10	11	12	3	4	5	6	7	8	9	3	4	5	6	7	8	9	7	8	9	10	11	12	13
13	14	15	16	17	18	19	10	11	12	13	14	15	16	10	11	12	13	14	15	16	14	15	16	17	18	19	20
20	21	22	23	24	25	26	17	18	19	20	21	22	23	17	18	19	20	21	22	23	21	22	23	24	25	26	27
27	28	29	30	31			24	25	26	27	28			24	25	26	27	28	29	30	28	29	30				
														31													
May 2025							June 2025							July 2025							August 2025						
M	T	W	T	F	S	S	M	T	W	T	F	S	S	M	T	W	T	F	S	S	M	T	W	T	F	S	S
			1	2	3	4						1		1	2	3	4	5	6					1	2	3	
5	6	7	8	9	10	11	2	3	4	5	6	7	8	7	8	9	10	11	12	13	4	5	6	7	8	9	10
12	13	14	15	16	17	18	9	10	11	12	13	14	15	14	15	16	17	18	19	20	11	12	13	14	15	16	17
19	20	21	22	23	24	25	16	17	18	19	20	21	22	21	22	23	24	25	26	27	18	19	20	21	22	23	24
26	27	28	29	30	31		23	24	25	26	27	28	29	28	29	30	31				25	26	27	28	29	30	31
							30																				

<div style="border: 1px solid black; width: 20px; height: 10px; margin: 0 auto;"></div> = Schooldays	<div style="border: 1px solid black; width: 20px; height: 10px; background-color: #f4a460; margin: 0 auto;"></div> = School holidays	<div style="border: 1px solid black; width: 20px; height: 10px; background-color: #333; margin: 0 auto;"></div> = Bank holidays	
<div style="border: 1px solid black; width: 20px; height: 10px; background-color: #ccc; margin: 0 auto;"></div> = Weekends	<div style="border: 1px solid black; width: 20px; height: 10px; background-color: #ffff00; margin: 0 auto;"></div> = Inset Days		

In addition, schools allocate five non-pupil days out of the school days indicated, or the equivalent in disaggregated twilight sessions.

Autumn Term:	Monday 2 September 2024 – Friday 20 December 2024 <i>Half Term 28 October – 1 November</i>	75 days
Spring Term:	Monday 6 January 2025 – Friday 4 April 2025 <i>Half Term 17 February - 21 February</i>	60 days
Summer Term:	Tuesday 22 April 2025 – Tuesday 22 July 2025 <i>Half Term 26 May – 30 May, and May Bank Holiday - 5 May</i>	60 days
		195 days

Please note:

The above dates may vary for individual schools, especially Foundation, Voluntary Aided schools and Academies.

You are strongly advised to check with your child's school before making any holiday or other commitments.